

# TR Series

## Rotary Wheel Dryer

### Benefits:

- Attractive stainless steel enclosure
- Advanced molecular sieve technology
- High pressure side channel blowers
- Advanced dryer filtration system
- FC-TR control
- Datalogger, dewpoint control and MaterialSaver functions
- SPI protocol and communications
- Interface with FACS control and monitoring

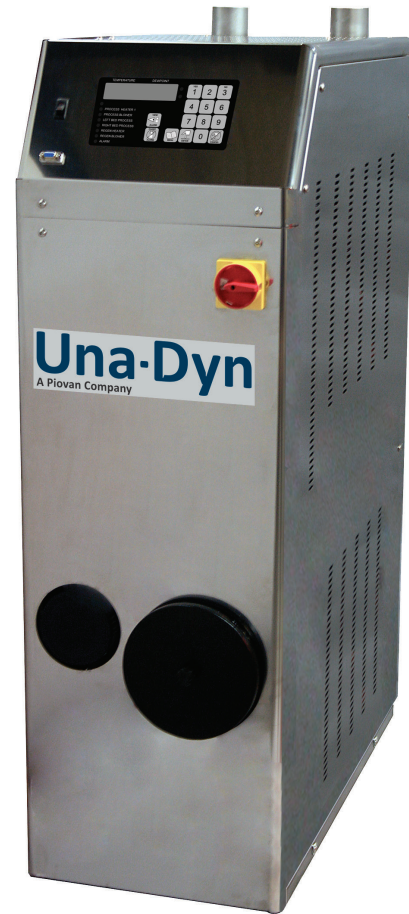

The TR series rotary wheel dryer is manufactured using advanced molecular sieve technology. Energy efficiency, simplicity and reliability are built into every function. Stable temperature and dewpoint control throughout the drying cycle ensures a solid performance capable of handling some of the industries most demanding resin drying applications. In addition, a unique heat recovery system lowers energy costs by up to 30% over more conventional rotary wheel drying systems on the market today.

All components are housed in a durable mirrored stainless steel enclosure with side panels that are easily removed for access to key components. Using two side channel blowers, one blower delivers air for the process heating

and cooling zones while the other is used for regeneration. The wheel assembly is housed in stainless steel, compact enclosure and features a positive grooved belt to ensure uniform, constant rotation. Using only six watts of power, the chamber rotates approximately one revolution every seven minutes.

In addition to a low power wheel drive, the TR series features an advanced heat recovery and filtration system. Ideal for the most stringent and demanding applications, such as clean rooms, medical and optical applications, these features ensure optimal energy consumption and protect the wheel by eliminating virtually all dust.

## Simple Dryer Operation in Three Continuous Phases:

Return air from the drying hopper passes through the active zone of the wheel and releases moisture. Higher temperature regeneration air passes through the wheel regeneration zone, reactivating the zone. Process air is used to cool down the wheel reactivation zone to condition the wheel for rotation into the active zone thus also rotating the existing saturated active zone back into the regeneration zone.

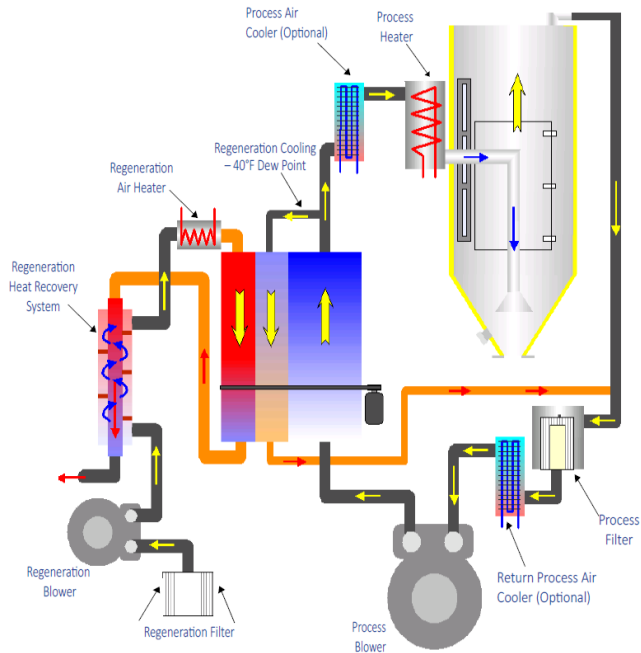

The TR series dryer is available in four sizes, TR-50, TR-100, TR-150 and TR-200. A variety of configurations are possible, depending on the application specifications.

Portable, beside the press or small central drying with multiple drying hoppers, there is a TR series rotary wheel dryer to meet your low throughput application demands!

## CONTROLS:

### FC-TR control

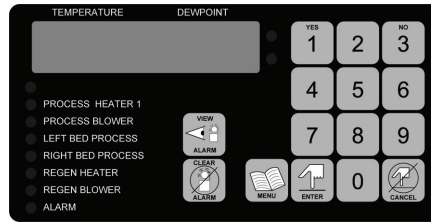

The FC-TR control is standard on the TR series rotary wheel dryer. An impressive list of features include:

- Datalogging capability
- Control of two process heaters
- Dewpoint control with or without the use of a dewpoint sensor
- SPI protocol and RS 232 serial communications
- SQC function - includes averaging and standard deviation calculation of up to two drying hoppers
- Seven day clock - Store up to 10 batch commands
- Three phase current monitoring with optional current donuts
- Communications with Una-Dyn's FACS (Factory Acquisition Control and Monitoring System)
- Optional remote display

Download, store and use data to assist with troubleshooting issues or to schedule preventative maintenance that may not be obvious during routine maintenance.

More control for efficient use of energy, time and other valuable resources!